



**PETROCHEM**  
BIOFLO SOLUTIONS





**PETROCHEM**  
GROUP

***Here at the Petrochem Group, we take pride in servicing your ASME BPE requirements, no matter how large or small your demands are.***

- **Stock**, with extensive stocks held at our operations in Cork & Meath, sourced via our long-term manufacturing partners in bulk quantities to ensure we can pass on any economies of scale achieved to our customers.
- **Team**, our dedicated sales team provide in-depth knowledge of not only ASME BPE tube & fittings, but also other critical clean technologies such as clamps and sanitary gaskets.
- **Speed**, all of this is supported by our dedicated operations team and bar-coded inventory to bring automation to our order completion, to ensure we deliver your product on time, at all times.
- **Quality**, our manufacturing partners are ASME BPE certified, to bring an additional level of quality assurance.



***All ASME BPE products held are in TP316/L grade of Stainless Steel***

***Further options for higher alloys such as AL6XN and C22 Hastalloy are available.***

***Hygienic classes held ex stock are SF1 and SF4.***

# Tubes

## BPE DT-4-1 (DT-1) Stainless Steel Tube

Nominal Size		Tube Wall Thickness		SF1	SF4
Inch	mm	Inch	mm	##=F1	##=F4
1/4	6.35	0.035	0.89	DT1B025089-##	
3/8	9.53	0.035	0.89	DT1B038089-##	
1/2	12.70	0.065	1.65	DT1B050165-##	
3/4	19.05	0.065	1.65	DT1B075165-##	
1	25.40	0.065	1.65	DT1B100165-##	
1 1/2	38.10	0.065	1.65	DT1B150165-##	
2	50.80	0.065	1.65	DT1B200165-##	
2 1/2	63.50	0.065	1.65	DT1B250165-##	
3	76.20	0.065	1.65	DT1B300165-##	
4	101.60	0.083	2.11	DT1B400211-##	
6	152.40	0.109	2.77	DT1B600277-##	

## All Fittings Comply with ASME

### BPE Table DT-3-1

### Final Tolerances for Mechanically Polished Fittings and Process Components

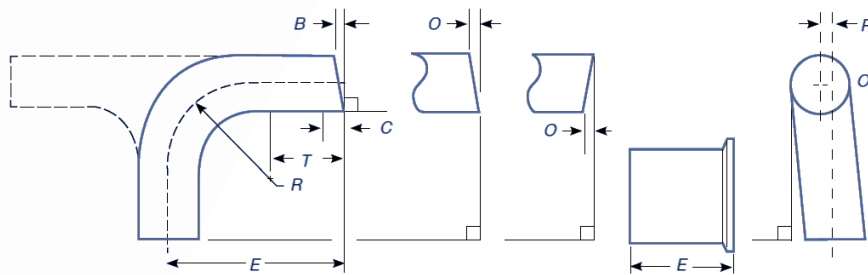

Nominal Size, in.	O.D.		Wall Thickness		Squareness Face to Tangent		Off Angles		Equivalent Angel (for O) deg	Off Plane, P		Centerline Radius (CLR), R	
	inch	mm	inch	mm	inch	mm	inch	mm		inch	mm	inch	mm
1/4	±0.005	±0.13	+0.003/-0.004	+0.08/-0.10	0.005	0.13	0.009	0.23	2.1	0.030	0.76	0.563	14.3
3/8	±0.005	±0.13	+0.003/-0.004	+0.08/-0.10	0.005	0.13	0.012	0.30	1.8	0.030	0.76	1.125	28.58
1/2	±0.005	±0.13	+0.005/-0.008	+0.13/-0.20	0.005	0.13	0.014	0.36	1.6	0.030	0.76	1.125	28.58
3/4	±0.005	±0.13	+0.005/-0.008	+0.13/-0.20	0.005	0.13	0.018	0.46	1.4	0.030	0.76	1.125	28.58
1	±0.005	±0.13	+0.005/-0.008	+0.13/-0.20	0.008	0.20	0.025	0.64	1.4	0.030	0.76	1.5	38.1
1 1/2	±0.008	±0.20	+0.005/-0.008	+0.13/-0.20	0.008	0.20	0.034	0.86	1.3	0.050	1.27	2.25	57.1
2	±0.008	±0.20	+0.005/-0.008	+0.13/-0.20	0.008	0.20	0.043	1.09	1.2	0.050	1.27	3.000	76.2
2 1/2	±0.010	±0.25	+0.005/-0.008	+0.13/-0.20	0.010	0.25	0.054	1.37	1.2	0.050	1.27	3.750	95.25
3	±0.010	±0.25	+0.005/-0.008	+0.13/-0.20	0.016	0.41	0.068	1.73	1.3	0.050	1.27	4.500	114.30
4	±0.015	±0.38	+0.008/-0.010	+0.20/-0.25	0.016	0.41	0.086	2.18	1.2	0.060	1.52	6.000	152.40
6	±0.030	±0.76	+0.015/-0.015	+0.38/-0.38	0.030	0.76	0.135	3.43	1.3	0.060	1.52	9.000	228.60

#### General Notes:

- (a) Tolerance on end-to-end and center-to-end dimension E is ±0.050" (1.27 mm)
- (b) Tolerance for centerline radius (CLR) is ±10% of the nominal dimension
- (c) The length of the control portion C is fixed for all sizes at 0.75" (19 mm)

### Weld End Chemical Compositions (wt.%)

	C	Si	Mn	P	S	Ni	Cr	Mo
Min.	-	-	-	-	0.005	10.000	16.000	2.000
Max.	0.035	1.000	2.000	0.045	0.017	14.000	18.000	3.000

### BPE Process Contact Surface Finish Requirements Table SF-2.4-1

Surface Designation	Mechanically Polished Ra Max.	
	µin.	µm
SF0	No finish requirement	No finish requirement
SF1	20	0.51
SF2	25	0.64
SF3	30	0.76
Surface Designation	Electropolished Ra Max.	
	µin.	µm
SF4	15	0.38
SF5	20	0.51
SF6	25	0.64

## Acceptance Criteria for Metallic Process Contact Surface Finishes Table SF-2.2-1

Anomaly or Indication	Acceptance Criteria
Pits	If diameter <0.020" (0.51 mm) and bottom is shiny [Notes (1) and (2)]. Pits <0.003" (0.08 mm) diameter is irrelevant and acceptable.
Cluster of pits	No more than 4 pits per each ½" x ½" (13 mm x 13 mm) inspection window. The cumulative total diameter of all relevant pits shall not exceed 0.040" (1.02 mm).
Dents	None accepted [Note (3)].
Finishing marks	If Ra max. is met.
Welds	Welds used in the as-welded condition shall meet the requirements of MJ-8. Welds finished after welding shall be flush with the base metal, and concavity and convexity shall meet the requirements of MJ-8. Such finishing shall meet the Ra requirements of Table SF-2.4-1.
Nicks	None accepted.
Scratches	For tubing, if cumulative length is <12.0' (305 mm) per 20' (6.1 m) tube length or prorated and if depth is <0.003" (0.08 mm). For fittings, valves and other process components, if cumulative length is <0.25" (6.4 mm), depth <0.003" (0.08 mm), and Ra max. is met. For vessels, if length <0.50" (13 mm) at 0.003" (0.08 mm) depth and if <3 per inspection window [Note (4)].
Surface cracks	None accepted.
Surface inclusions	If Ra max. is met.
Surface residuals	None accepted, visual inspection.
Surface roughness (Ra)	See Table SF-2.4-1.
Weld slag	For tubing, up to 3 per 20' (6.1 m) length or prorated, if <75% of the width of the weld bead. For fittings, valves, vessels, and other process components, none accepted (as welded shall meet the requirements of MJ-8 and Table MJ-8.4-1).
Porosity	None open to the surface.
Buffing	None accepted.

### General Notes :

- (1) Black bottom pit of any depth is not acceptable.
- (2) Pits in super-austenitic and nickel alloys may exceed this value. Acceptance criteria for pit size shall be established by agreement between owner/user and supplier. All other pit criteria remain the same.
- (3) For vessels, dents in the area covered by and resulting from welding dimple heat transfer jackets are acceptable.
- (4) An inspection window is defined as an area 4" x 4" (100 mm x 100 mm).

## Additional Acceptance Criteria for Electropolished Metallic Process Contact Surface Finishes Table SF-2.2-2

Anomaly or Indication	Acceptance Criteria
Blistering	None accepted
Buffering	None accepted
Cloudiness	None accepted
End grain effect	Acceptable if Ra max. is met
Fixture marks	Acceptable if electropolished
Haze	None accepted
Orange peel	Acceptable if Ra max. is met
Stringer indication	Acceptable if Ra max. is met
Weld whitening	Acceptable if Ra max. is met
Variance in luster	Acceptable if Ra max. is met

### Reference

- American Society of Mechanical Engineers, 2014. 'ASME BPE-2014 Bioprocessing Equipment', Part DT Dimensions and Tolerances for Process Components: 96
- ASTM International, 2015. 'A270/A270M-15', Table 1 Chemical Requirements: 3
- American Society of Mechanical Engineers, 2014. 'ASME BPE-2014 Bioprocessing Equipment', Part SF Process Contact Surface Finishes: 141, 142

# BPE Tube Fittings

## DT-7

DT-4.1.1-1

90° Elbow WW

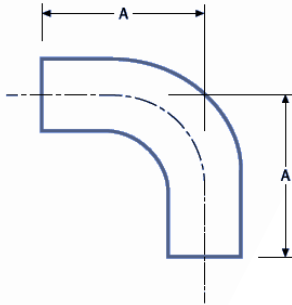

Nominal Size		A		SF1	SF4
Inch	mm	Inch	mm	##=F1	##=F4
1/4	6.35	2.625	66.70	DT790B025-##	
3/8	9.53	2.625	66.70	DT790B038-##	
1/2	12.70	3.000	76.20	DT790B050-##	
3/4	19.05	3.000	76.20	DT790B075-##	
1	25.40	3.000	76.20	DT790B100-##	
1 1/2	38.10	3.750	95.30	DT790B150-##	
2	50.80	4.750	120.70	DT790B200-##	
2 1/2	63.50	5.500	139.70	DT790B250-##	
3	76.20	6.250	158.80	DT790B300-##	
4	101.60	8.000	203.20	DT790B400-##	
6	152.40	11.500	292.10	DT790B600-##	

## DT-8

DT-4.1.1-4

45° Elbow WW

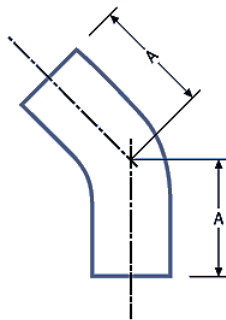

Nominal Size		A		SF1	SF4
Inch	mm	Inch	mm	##=F1	##=F4
1/4	6.35	2.000	50.80	DT845B025-##	
3/8	9.53	2.000	50.80	DT845B038-##	
1/2	12.70	2.250	57.20	DT845B050-##	
3/4	19.05	2.250	57.20	DT845B075-##	
1	25.40	2.250	57.20	DT845B100-##	
1 1/2	38.10	2.500	63.50	DT845B150-##	
2	50.80	3.000	76.20	DT845B200-##	
2 1/2	63.50	3.375	85.70	DT845B250-##	
3	76.20	3.625	92.10	DT845B300-##	
4	101.60	4.500	114.30	DT845B400-##	
6	152.40	6.250	158.80	DT845B600-##	

## DT -9

DT-4.1.2-1

Equal Tee WWW

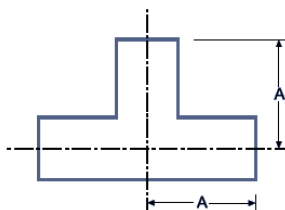

Nominal Size		A		SF1	SF4
Inch	mm	Inch	mm	##=F1	##=F4
1/4	6.35	1.750	44.50	DT9B025-##	
3/8	9.53	1.750	44.50	DT9B038-##	
1/2	12.70	1.875	47.60	DT9B050-##	
3/4	19.05	2.000	50.80	DT9B075-##	
1	25.40	2.125	54.00	DT9B100-##	
1 1/2	38.10	2.375	60.30	DT9B150-##	
2	50.80	2.875	73.00	DT9B200-##	
2 1/2	63.50	3.125	79.40	DT9B250-##	
3	76.20	3.375	85.70	DT9B300-##	
4	101.60	4.125	104.80	DT9B400-##	
6	152.40	5.625	142.90	DT9B600-##	

# DT 9C

DT-4.1.2-1

Equal Cross WWWW

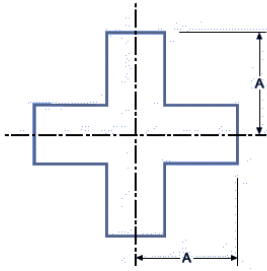

Nominal Size		A		SF1	SF4
Inch	mm	Inch	mm	##=F1	##=F4
1/4	6.35	1.750	44.50		DT9CB025-##
3/8	9.53	1.750	44.50		DT9CB038-##
1/2	12.70	1.875	47.60		DT9CB050-##
3/4	19.05	2.000	50.80		DT9CB075-##
1	25.40	2.125	54.00		DT9CB100-##
1 1/2	38.10	2.375	60.30		DT9CB150-##
2	50.80	2.875	73.00		DT9CB200-##
2 1/2	63.50	3.125	79.40		DT9CB250-##
3	76.20	3.375	85.70		DT9CB300-##
4	101.60	4.125	104.80		DT9CB400-##
6	152.40	5.625	142.90		DT9CB400-##

# DT-10

## DT-4.1.2-6

### Reducing Tee WWW

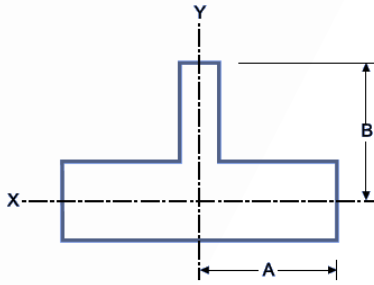

Nominal Size		A		B		SF1	SF4
Inch	mm	Inch	mm	Inch	mm	##=F1	##=F4
3/8 x 1/4	9.53 x 6.35	1.750	44.50	1.750	44.50	DT10RTB038025-##	
1/2 x 1/4	12.70 x 6.35	1.875	47.60	1.875	47.60	DT10RTB050025-##	
1/2 x 3/8	12.70 x 9.53	1.875	47.60	1.875	47.60	DT10RTB050038-##	
3/4 x 1/4	19.05 x 6.35	2.000	50.80	2.000	50.80	DT10RTB075025-##	
3/4 x 3/8	19.05 x 9.53	2.000	50.80	2.000	50.80	DT10RTB075038-##	
3/4 x 1/2	19.05 x 12.70	2.000	50.80	2.000	50.80	DT10RTB075050-##	
1 x 1/4	25.40 x 6.35	2.125	54.00	2.125	54.00	DT10RTB100025-##	
1 x 3/8	25.40 x 9.53	2.125	54.00	2.125	54.00	DT10RTB100038-##	
1 x 1/2	25.40 x 12.70	2.125	54.00	2.125	54.00	DT10RTB100050-##	
1 x 3/4	25.40 x 19.05	2.125	54.00	2.125	54.00	DT10RTB100075-##	
1 1/2 x 1/2	38.10 x 12.70	2.375	60.30	2.375	60.30	DT10RTB150050-##	
1 1/2 x 3/4	38.10 x 19.05	2.375	60.30	2.375	60.30	DT10RTB150075-##	
1 1/2 x 1	38.10 x 25.40	2.375	60.30	2.375	60.30	DT10RTB150100-##	
2 x 1/2	50.80 x 12.70	2.875	73.00	2.625	66.70	DT10RTB200050-##	
2 x 3/4	50.80 x 19.05	2.875	73.00	2.625	66.70	DT10RTB200075-##	
2 x 1	50.80 x 25.40	2.875	73.00	2.625	66.70	DT10RTB200100-##	
2 x 1 1/2	50.80 x 38.10	2.875	73.00	2.625	66.70	DT10RTB200150-##	
2 1/2 x 1/2	63.50 x 12.70	3.125	79.40	2.875	73.00	DT10RTB250050-##	
2 1/2 x 3/4	63.50 x 19.05	3.125	79.40	2.875	73.00	DT10RTB250075-##	
2 1/2 x 1	63.50 x 25.40	3.125	79.40	2.875	73.00	DT10RTB250100-##	
2 1/2 x 1 1/2	63.50 x 38.10	3.125	79.40	2.875	73.00	DT10RTB250150-##	
2 1/2 x 2	63.50 x 50.80	3.125	79.40	2.875	73.00	DT10RTB250200-##	
3 x 1/2	76.20 x 12.70	3.375	85.70	3.125	79.40	DT10RTB300050-##	
3 x 3/4	76.20 x 19.05	3.375	85.70	3.125	79.40	DT10RTB300075-##	
3 x 1	76.20 x 25.40	3.375	85.70	3.125	79.40	DT10RTB300100-##	
3 x 1 1/2	76.20 x 38.10	3.375	85.70	3.125	79.40	DT10RTB300150-##	
3 x 2	76.20 x 50.80	3.375	85.70	3.125	79.40	DT10RTB300200-##	
3 x 2 1/2	76.20 x 63.50	3.375	85.70	3.125	79.40	DT10RTB300250-##	
4 x 1/2	101.60 x 12.70	4.125	104.80	3.625	92.10	DT10RTB400050-##	
4 x 3/4	101.60 x 19.05	4.125	104.80	3.625	92.10	DT10RTB400075-##	
4 x 1	101.60 x 25.40	4.125	104.80	3.625	92.10	DT10RTB400100-##	
4 x 1 1/2	101.60 x 38.10	4.125	104.80	3.625	92.10	DT10RTB400150-##	
4 x 2	101.60 x 50.80	4.125	104.80	3.875	98.40	DT10RTB400200-##	
4 x 2 1/2	101.60 x 63.50	4.125	104.80	3.875	98.40	DT10RTB400250-##	
4 x 3	101.60 x 76.20	4.125	104.80	3.875	98.40	DT10RTB400300-##	
6 x 3	152.40 x 76.20	5.625	142.90	4.875	123.80	DT10RTB600300-##	
6 x 4	152.40 x 101.60	5.625	142.90	5.125	130.20	DT10RTB600400-##	



# DT - 11C(a)

Concentric Reducer WW

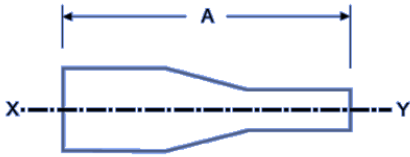

Nominal size	A		SF1	SF4
	Inch	mm	Inch	mm
3/8x1/4	9.53 x 6.35	3.250	82.60	DT11CB038025-##
1/2x1/4	12.70 x 6.35	3.250	82.60	DT11CB050025-##
1/2x3/8	12.70 x 9.53	3.250	82.60	DT11CB050038-##
3/4x1/4	19.05 x 6.35	3.250	82.60	DT11CB075025-##
3/4x3/8	19.05 x 9.53	3.250	82.60	DT11CB075038-##
3/4x1/2	19.05 x 12.70	4.000	101.60	DT11CB075050-##
1x1/4	25.40 x 6.35	4.500	114.30	DT11CB100025-##
1x3/8	25.40 x 9.53	4.500	114.30	DT11CB100038-##
1x1/2	25.40 x 12.70	4.500	114.30	DT11CB100050-##
1x3/4	25.40 x 19.05	4.000	101.60	DT11CB100075-##
1 1/2x1/2	38.10 x 12.70	5.500	139.70	DT11CB150050-##
1 1/2x3/4	38.10 x 19.05	5.000	127.00	DT11CB150075-##
1 1/2x1	38.10 x 25.40	5.000	127.00	DT11CB150100-##
2x1/2	50.80 x 12.70	7.750	196.90	DT11CB200050-##
2x3/4	50.80 x 19.05	7.250	184.20	DT11CB200075-##
2 x 1	50.80 x 25.40	7.250	184.20	DT11CB200100-##
2 x 1 1/2	50.80 x 38.10	5.250	133.40	DT11CB200150-##
2 1/2x1/2	63.50 x 12.70	9.750	247.70	DT11CB250050-##
2 1/2x3/4	63.50 x 19.05	9.250	235.00	DT11CB250075-##
2 1/2x1	63.50 x 25.40	9.250	235.00	DT11CB250100-##
2 1/2x1 1/2	63.50 x 38.10	7.250	184.20	DT11CB250150-##
2 1/2x2	63.50 x 50.80	5.500	139.70	DT11CB250200-##
3 x 1	76.20 x 25.40	11.250	285.80	DT11CB300100-##
3 x 1 1/2	76.20 x 38.10	9.250	235.00	DT11CB300150-##
3 x 2	76.20 x 50.80	7.500	190.50	DT11CB300200-##
3 x 2 1/2	76.20 x 63.50	5.500	139.70	DT11CB300250-##
4 x 1	101.60 x 25.40	15.500	393.70	DT11CB400100-##
4 x 1 1/2	101.60 x 38.10	13.500	342.90	DT11CB400150-##
4 x 2	101.60 x 50.80	11.750	298.50	DT11CB400200-##
4 x 2 1/2	101.60 x 63.50	9.750	247.70	DT11CB400250-##
4 x 3	101.60 x 76.20	7.750	196.90	DT11CB400300-##
6 x 3	152.40 x 76.20	10.000	254.00	DT11CB600300-##
6 x 4	152.40 x 101.60	10.000	254.00	DT11CB600400-##

# DT - 11C(a)

Concentric Reducer WW



Nominal size	B		SF1	SF4
	Inch	mm	Inch	mm
3/8x1/4	9.53 x 6.35	4.000	101.60	DT11EB038025-##
1/2x1/4	12.70 x 6.35	4.000	101.60	DT11EB050025-##
1/2x3/8	12.70 x 9.53	4.000	101.60	DT11EB050038-##
3/4x1/4	19.05 x 6.35	4.000	101.60	DT11EB038025-##
3/4x3/8	19.05 x 9.53	4.000	101.60	DT11EB075038-##
3/4x1/2	19.05 x 12.70	4.000	101.60	DT11EB075050-##
1 x 1/4	25.40 x 6.35	4.500	114.30	DT11EB100025-##
1 x 3/8	25.40 x 9.53	4.500	114.30	DT11EB100038-##
1 x 1/2	25.40 x 12.70	4.500	114.30	DT11EB100050-##
1 x 3/4	25.40 x 19.05	4.000	101.60	DT11EB100075-##
1 1/2x1/2	38.10 x 12.70	5.500	139.70	DT11EB150050-##
1 1/2x3/4	38.10 x 19.05	5.000	127.00	DT11EB150075-##
1 1/2x1	38.10 x 25.40	5.000	127.00	DT11EB150075-##
2 x 1/2	50.80 x 12.70	7.750	196.90	DT11EB200050-##
2 x 3/4	50.80 x 19.05	7.250	184.20	DT11EB200075-##
2 x 1	50.80 x 25.40	7.250	184.20	DT11EB200100-##
2 x 1 1/2	50.80 x 38.10	5.250	133.40	DT11EB200150-##
2 1/2x1/2	63.50 x 12.70	9.750	247.70	DT11EB250050-##
2 1/2x3/4	63.50 x 19.05	9.250	235.00	DT11EB250075-##
2 1/2x1	63.50 x 25.40	9.250	235.00	DT11EB250100-##
2 1/2x1 1/2	63.50 x 38.10	7.250	184.20	DT11EB250150-##
2 1/2x2	63.50 x 50.80	5.500	139.70	DT11EB250200-##
3 x 1	76.20 x 25.40	11.250	285.80	DT11EB300100-##
3 x 1 1/2	76.20 x 38.10	9.250	235.00	DT11EB300150-##
3 x 2	76.20 x 50.80	7.500	190.50	DT11EB300200-##
3 x 2 1/2	76.20 x 63.50	5.500	139.70	DT11EB300250-##
4 x 1	101.60 x 25.40	15.500	393.70	DT11EB400100-##
4 x 1 1/2	101.60 x 38.10	13.500	342.90	DT11EB400150-##
4 x 2	101.60 x 50.80	11.750	298.50	DT11EB400200-##
4 x 2 1/2	101.60 x 63.50	9.750	247.70	DT11EB400250-##
4 x 3	101.60 x 76.20	7.750	196.90	DT11EB400300-##
6 x 3	152.40 x 76.20	9.750	247.70	DT11EB600300-##
6 x 4	152.40 x 101.60	10.000	254.00	DT11EB600400-##

## DT - 11C(b)

BPE DT -4.1.3-1  
Concentric Reducer WW

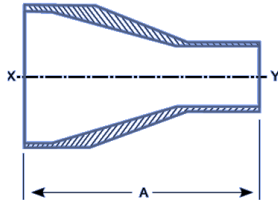

Nominal Size		A		SF1	SF4
Inch	mm	Inch	mm	##=F1	##=F4
3/8x1/4	9.53 x 6.35	1.625	41.30	DT11CBB038025-##	
1/2x1/4	12.70 x 6.35	1.875	47.60	DT11CBB050025-##	
1/2x3/8	12.70 x 9.53	1.875	47.60	DT11CBB050038-##	
3/4x3/8	19.05 x 9.53	2.000	50.80	DT11CBB075038-##	
3/4x1/2	19.05 x 12.70	2.125	54.00	DT11CBB075050-##	
1 x 1/2	25.40 x 12.70	2.500	63.50	DT11CBB100050-##	
1 x 3/4	25.40 x 19.05	2.125	54.00	DT11CBB100075-##	
1 1/2 x 3/4	38.10 x 19.05	3.000	76.20	DT11CBB150075-##	
1 1/2 x 1	38.10 x 25.40	2.500	63.50	DT11CBB150100-##	
2 x 1	50.80 x 25.40	3.375	85.70	DT11CBB200100-##	
2 x 1 1/2	50.80 x 38.10	2.500	63.50	DT11CBB200150-##	
2 1/2 x 1 1/2	63.50 x 38.10	3.375	85.70	DT11CBB250150-##	
2 1/2 x 2	63.50 x 50.80	2.500	63.50	DT11CBB250200-##	
3 x 1 1/2	76.20 x 38.10	4.250	108.00	DT11CBB300150-##	
3 x 2	76.20 x 50.80	3.375	85.70	DT11CBB300200-##	
3 x 2 1/2	76.20 x 63.50	2.625	66.70	DT11CBB300250-##	
4 x 2	101.60 x 50.80	5.125	130.20	DT11CBB400200-##	
4 x 2 1/2	101.60 x 63.50	4.250	108.00	DT11CBB400250-##	
4 x 3	101.60 x 76.20	3.875	98.40	DT11CBB400300-##	
6 x 3	152.40 x 76.20	7.250	184.20	DT11CBB600300-##	
6 x 4	152.40 x 101.60	5.625	142.90	DT11CBB600400-##	

## DT - 11E(b)

BPE DT -4.1.3-1  
Eccentric Reducer WW

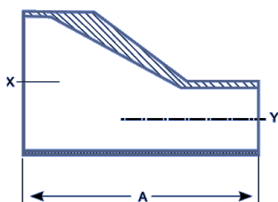

Nominal Size		A		SF1	SF4
Inch	mm	Inch	mm	##=F1	##= F4
3/8x1/4	9.53 x 6.35	1.625	41.30	DT11EBB038025-##	
1/2x1/4	12.70 x 6.35	1.875	47.60	DT11EBB050025-##	
1/2x3/8	12.70 x 9.53	1.875	47.60	DT11EBB050038-##	
3/4x3/8	19.05 x 9.53	2.000	50.80	DT11EBB075038-##	
3/4x1/2	19.05 x 12.70	2.125	54.00	DT11EBB075050-##	
1 x 1/2	25.40 x 12.70	2.500	63.50	DT11EBB100050-##	
1 x 3/4	25.40 x 19.05	2.125	54.00	DT11EBB100075-##	
1 1/2 x 3/4	38.10 x 19.05	3.000	76.20	DT11EBB150075-##	
1 1/2 x 1	38.10 x 25.40	2.500	63.50	DT11EBB150100-##	
2 x 1	50.80 x 25.40	3.375	85.70	DT11EBB200100-##	
2 x 1 1/2	50.80 x 38.10	2.500	63.50	DT11EBB200150-##	
2 1/2 x 1 1/2	63.50 x 38.10	3.375	85.70	DT11EBB250150-##	
2 1/2 x 2	63.50 x 50.80	2.500	63.50	DT11EBB250200-##	
3 x 1 1/2	76.20 x 38.10	4.250	108.00	DT11EBB300150-##	
3 x 2	76.20 x 50.80	3.375	85.70	DT11EBB300200-##	
3 x 2 1/2	76.20 x 63.50	2.625	66.70	DT11EBB300250-##	
4 x 2	101.60 x 50.80	5.125	130.20	DT11EBB400200-##	
4 x 2 1/2	101.60 x 63.50	4.250	108.00	DT11EBB400250-##	
4 x 3	101.60 x 76.20	3.875	98.40	DT11EBB400300-##	
6 x 3	152.40 x 76.20	7.250	184.20	DT11EBB600300-##	
6 x 4	152.40 x 101.60	5.625	142.90	DT11EBB600400-##	

# DT-12

## DT-4.1.1-2

### 90° Elbow CW

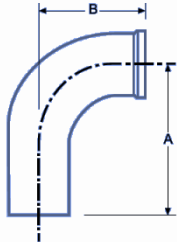

Nominal Size		A		B		SF1	SF4
Inch	mm	Inch	mm	Inch	mm	##=F1	##=F4
1/4	6.35	2.625	66.70	1.625	41.30	DT1290B025-##	
3/8	9.53	2.625	66.70	1.625	41.30	DT1290B038-##	
1/2	12.70	3.000	76.20	1.625	41.30	DT1290B050-##	
3/4	19.05	3.000	76.20	1.625	41.30	DT1290B075-##	
1	25.40	3.000	76.20	2.000	50.80	DT1290B100-##	
1 1/2	38.10	3.750	95.30	2.750	69.90	DT1290B150-##	
2	50.80	4.750	120.70	3.500	88.90	DT1290B200-##	
2 1/2	63.50	5.500	139.70	4.250	108.00	DT1290B250-##	
3	76.20	6.250	158.80	5.000	127.00	DT1290B300-##	
4	101.60	8.000	203.20	6.625	168.20	DT1290B400-##	
6	152.40	11.500	292.10	10.500	266.70	DT1290B600-##	

# DT-13

## DT-4.1.1-5

### 45° Elbow CW

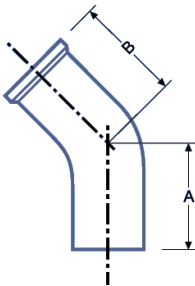

Nominal Size		A		B		SF1	SF4
Inch	mm	Inch	mm	Inch	mm	##=F1	##=F4
1/4	6.35	2.000	50.80	1.000	25.40	DT1345B025-##	
3/8	9.53	2.000	50.80	1.000	25.40	DT1345B038-##	
1/2	12.70	2.250	57.20	1.000	25.40	DT1345B050-##	
3/4	19.05	2.250	57.20	1.000	25.40	DT1345B075-##	
1	25.40	2.250	57.20	1.125	28.60	DT1345B100-##	
1 1/2	38.10	2.500	63.50	1.438	36.50	DT1345B150-##	
2	50.80	3.000	76.20	1.750	44.50	DT1345B200-##	
2 1/2	63.50	3.375	85.70	2.063	52.40	DT1345B250-##	
3	76.20	3.625	92.10	2.375	60.30	DT1345B300-##	
4	101.60	4.500	114.30	3.125	79.40	DT1345B400-##	
6	152.40	6.250	158.80	5.250	133.40	DT1345B600-##	

# DT-14

## DT-4.1.2-7

Short Outlet Reducing Tee WCW

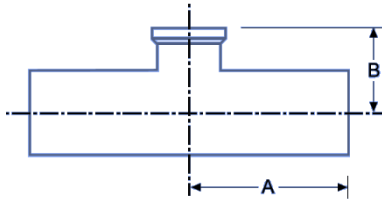

Nominal Size		A		B		SF1	SF4
Inch	mm	Inch	mm	Inch	mm	##=F1	##=F4
3/8 x 1/4	9.53 x 6.35	1.750	44.50	1.000	25.40	DT14RTB038025-##	
1/2 x 1/4	12.70 x 6.35	1.875	47.60	1.000	25.40	DT14RTB050025-##	
1/2 x 3/8	12.70 x 9.53	1.875	47.60	1.000	25.40	DT14RTB050038-##	
3/4 x 3/8	19.05 x 9.53	2.000	50.80	1.000	25.40	DT14RTB075038-##	
3/4 x 1/2	19.05 x 12.70	2.000	50.80	1.000	25.40	DT14RTB075050-##	
1 x 1/4	25.40 x 6.35	2.125	54.00	1.125	28.60	DT14RTB100025-##	
1 x 3/8	25.40 x 9.53	2.125	54.00	1.125	28.60	DT14RTB100038-##	
1 x 1/2	25.40 x 12.70	2.125	54.00	1.125	28.60	DT14RTB100050-##	
1 x 3/4	25.40 x 19.05	2.125	54.00	1.125	28.60	DT14RTB100075-##	
1 1/2 x 1/2	38.10 x 12.70	2.375	60.30	1.375	34.90	DT14RTB150050-##	
1 1/2 x 3/4	38.10 x 19.05	2.375	60.30	1.375	34.90	DT14RTB150075-##	
1 1/2 x 1	38.10 x 25.40	2.375	60.30	1.375	34.90	DT14RTB150100-##	
2 x 1/2	50.80 x 12.70	2.875	73.00	1.625	41.30	DT14RTB200050-##	
2 x 3/4	50.80 x 19.05	2.875	73.00	1.625	41.30	DT14RTB200075-##	
2 x 1	50.80 x 25.40	2.875	73.00	1.625	41.30	DT14RTB200100-##	
2 x 1 1/2	50.80 x 38.10	2.875	73.00	1.625	41.30	DT14RTB200150-##	
2 1/2 x 1/2	63.50 x 12.70	3.125	79.40	1.875	47.60	DT14RTB250050-##	
2 1/2 x 3/4	63.50 x 19.05	3.125	79.40	1.875	47.60	DT14RTB250075-##	
2 1/2 x 1	63.50 x 25.40	3.125	79.40	1.875	47.60	DT14RTB250100-##	
2 1/2 x 1 1/2	63.50 x 38.10	3.125	79.40	1.875	47.60	DT14RTB250150-##	
2 1/2 x 2	63.50 x 50.80	3.125	79.40	1.875	47.60	DT14RTB250200-##	
3 x 1/2	76.20 x 12.70	3.375	85.70	2.125	54.00	DT14RTB300050-##	
3 x 3/4	76.20 x 19.05	3.375	85.70	2.125	54.00	DT14RTB300075-##	
3 x 1	76.20 x 25.40	3.375	85.70	2.125	54.00	DT14RTB300100-##	
3 x 1 1/2	76.20 x 38.10	3.375	85.70	2.125	54.00	DT14RTB300150-##	
3 x 2	76.20 x 50.80	3.375	85.70	2.125	54.00	DT14RTB300200-##	
3 x 2 1/2	76.20 x 63.50	3.375	85.70	2.125	54.00	DT14RTB300250-##	
4 x 1/2	101.60 x 12.70	4.125	104.80	2.625	66.70	DT14RTB400050-##	
4 x 3/4	101.60 x 19.05	4.125	104.80	2.625	66.70	DT14RTB400075-##	
4 x 1	101.60 x 25.40	4.125	104.80	2.625	66.70	DT14RTB400100-##	
4 x 1 1/2	101.60 x 38.10	4.125	104.80	2.625	66.70	DT14RTB400150-##	
4 x 2	101.60 x 50.80	4.125	104.80	2.625	66.70	DT14RTB400200-##	
4 x 2 1/2	101.60 x 63.50	4.125	104.80	2.625	66.70	DT14RTB400250-##	
4 x 3	101.60 x 76.20	4.125	104.80	2.625	66.70	DT14RTB400300-##	
6 x 1/2	152.40 x 12.70	5.625	142.90	3.625	92.10	DT14RTB600050-##	
6 x 3/4	152.40 x 19.05	5.625	142.90	3.625	92.10	DT14RTB600075-##	
6 x 1	152.40 x 25.40	5.625	142.90	3.625	92.10	DT14RTB600100-##	
6 x 1 1/2	152.40 x 38.10	5.625	142.90	3.625	92.10	DT14RTB600150-##	
6 x 2	152.40 x 50.80	5.625	142.90	3.625	92.10	DT14RTB600200-##	
6 x 2 1/2	152.40 x 63.50	5.625	142.90	3.625	92.10	DT14RTB600250-##	
6 x 3	152.40 x 76.20	5.625	142.90	3.625	92.10	DT14RTB600300-##	
6 x 4	152.40 x 101.60	5.625	142.90	3.750	95.30	DT14RTB600400-##	

# DT-15

## DT-4.1.2-2

Short Outlet Equal Tee WCW

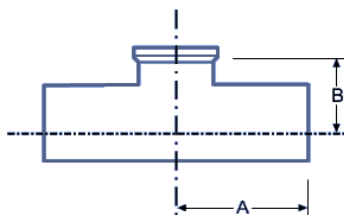

Nominal Size		A		B		SF1	SF4
Inch	mm	Inch	mm	Inch	mm	##=F1	##=F4
1/4	6.35	1.750	44.50	1.000	25.40	DT15ETB025-##	
3/8	9.53	1.750	44.50	1.000	25.40	DT15ETB038-##	
1/2	12.70	1.875	47.60	1.000	25.40	DT15ETB050-##	
3/4	19.05	2.000	50.80	1.125	28.60	DT15ETB075-##	
1	25.40	2.125	54.00	1.125	28.60	DT15ETB100-##	
1 1/2	38.10	2.375	60.30	1.375	34.90	DT15ETB150-##	
2	50.80	2.875	73.00	1.625	41.30	DT15ETB200-##	
2 1/2	63.50	3.125	79.40	1.875	47.60	DT15ETB250-##	
3	76.20	3.375	85.70	2.125	54.00	DT15ETB300-##	
4	101.60	4.125	104.80	2.750	69.90	DT15ETB400-##	
6	152.40	5.625	142.90	4.625	117.50	DT15ETB600-##	

# DT-16

## DT-4.1.1-3

90° Clamp Elbow CC

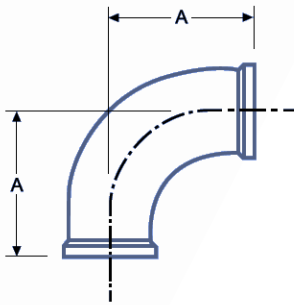

Nominal Size		A		SF1	SF4
Inch	mm	Inch	mm	##=F1	##=F4
1/4	6.35	1.625	41.30	DT1690B025-##	
3/8	9.53	1.625	41.30	DT1690B038-##	
1/2	12.70	1.625	41.30	DT1690B050-##	
3/4	19.05	1.625	41.30	DT1690B075-##	
1	25.40	2.000	50.80	DT1690B100-##	
1 1/2	38.10	2.750	69.90	DT1690B150-##	
2	50.80	3.500	88.90	DT1690B200-##	
2 1/2	63.50	4.250	108.00	DT1690B250-##	
3	76.20	5.000	127.00	DT1690B300-##	
4	101.60	6.625	168.30	DT1690B400-##	
6	152.40	10.500	266.70	DT1690B600-##	

# DT-17

## DT-4.1.1-6

45° Clamp Elbow CC

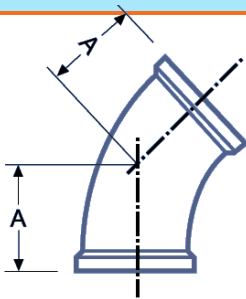

Nominal Size		A		SF1	SF4
Inch	mm	Inch	mm	##=F1	##=F4
1/4	6.35	1.000	25.40	DT1745B025-##	
3/8	9.53	1.000	25.40	DT1745B038-##	
1/2	12.70	1.000	25.40	DT1745B050-##	
3/4	19.05	1.000	25.40	DT1745B075-##	
1	25.40	1.125	28.60	DT1745B100-##	
1 1/2	38.10	1.438	36.50	DT1745B150-##	
2	50.80	1.750	44.50	DT1745B200-##	
2 1/2	63.50	2.063	52.40	DT1745B250-##	
3	76.20	2.375	60.30	DT1745B300-##	
4	101.60	3.125	79.40	DT1745B400-##	
6	152.40	5.250	133.40	DT1745B600-##	

# DT-18

## DT-4.1.2-4

Clamp Equal Tee CCC

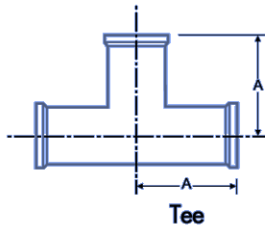

Tee

Nominal Size		A		SF1	SF4
Inch	mm	Inch	mm	##=F1	##=F4
1/4	6.35	2.250	57.20	DT18B025-##	
3/8	9.53	2.250	57.20	DT18B038-##	
1/2	12.70	2.250	57.20	DT18B050-##	
3/4	19.05	2.375	60.30	DT18B075-##	
1	25.40	2.625	66.70	DT18B100-##	
1 1/2	38.10	2.875	73.00	DT18B150-##	
2	50.80	3.375	85.70	DT18B200-##	
2 1/2	63.50	3.625	92.10	DT18B250-##	
3	76.20	3.875	98.40	DT18B300-##	
4	101.60	4.750	120.70	DT18B400-##	
6	152.40	7.125	181.00	DT18B600-##	

# DT-18C

## DT-4.1.2-4

Clamp Equal Cross

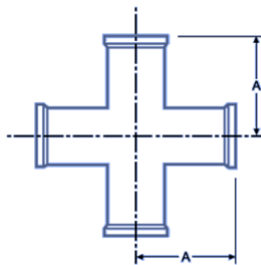

Cross

Nominal Size		A		SF1	SF4
Inch	mm	Inch	mm	##=F1	##=F4
1/4	6.35	2.250	57.20	DT18CB025-##	
3/8	9.53	2.250	57.20	DT18CB038-##	
1/2	12.70	2.250	57.20	DT18CB050-##	
3/4	19.05	2.375	60.30	DT18CB075-##	
1	25.40	2.625	66.70	DT18CB100-##	
1 1/2	38.10	2.875	73.00	DT18CB150-##	
2	50.80	3.375	85.70	DT18CB200-##	
2 1/2	63.50	3.625	92.10	DT18CB250-##	
3	76.20	3.875	98.40	DT18CB300-##	
4	101.60	4.750	120.70	DT18CB400-##	
6	152.40	7.125	181.00	DT18CB600-##	

# DT-19

## DT-4.1.2-8

### Clamp Reducing Tee CCC

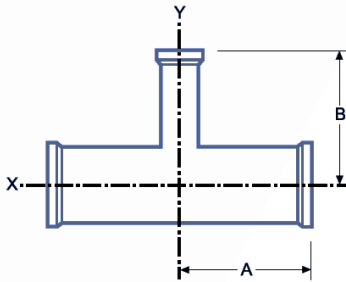

Nominal Size		A		B		SF1	SF4
Inch	mm	Inch	mm	Inch	mm	##=F1	##=F4
3/8 x 1/4	9.53 x 6.35	2.250	57.20	2.250	57.20	DT19RTB038025-##	
1/2 x 1/4	12.70 x 6.35	2.375	60.30	2.375	60.30	DT19RTB050025-##	
1/2 x 3/8	12.70 x 9.53	2.375	60.30	2.375	60.30	DT19RTB050038-##	
3/4 x 1/4	19.05 x 6.35	2.500	63.50	2.500	63.50	DT19RTB075025-##	
3/4 x 3/8	19.05 x 9.53	2.500	63.50	2.500	63.50	DT19RTB075038-##	
3/4 x 1/2	19.05 x 12.70	2.500	63.50	2.500	63.50	DT19RTB075050-##	
1 x 1/4	25.40 x 6.35	2.625	66.70	2.625	66.70	DT19RTB100025-##	
1 x 3/8	25.40 x 9.53	2.625	66.70	2.625	66.70	DT19RTB100038-##	
1 x 1/2	25.40 x 12.70	2.625	66.70	2.625	66.70	DT19RTB100050-##	
1 x 3/4	25.40 x 19.05	2.625	66.70	2.625	66.70	DT19RTB100075-##	
1 1/2 x 1/2	38.10 x 12.70	2.875	73.00	2.875	73.00	DT19RTB150075-##	
1 1/2 x 3/4	38.10 x 19.05	2.875	73.00	2.875	73.00	DT19RTB150075-##	
1 1/2 x 1	38.10 x 25.40	2.875	73.00	2.875	73.00	DT19RTB150100-##	
2 x 1/2	50.80 x 12.70	3.375	85.70	3.125	79.40	DT19RTB200050-##	
2 x 3/4	50.80 x 19.05	3.375	85.70	3.125	79.40	DT19RTB200075-##	
2 x 1	50.80 x 25.40	3.375	85.70	3.125	79.40	DT19RTB200100-##	
2 x 1 1/2	50.80 x 38.10	3.375	85.70	3.125	79.40	DT19RTB200150-##	
2 1/2 x 1/2	63.50 x 12.70	3.625	92.10	3.375	85.70	DT19RTB250050-##	
2 1/2 x 3/4	63.50 x 19.05	3.625	92.10	3.375	85.70	DT19RTB250075-##	
2 1/2 x 1	63.50 x 25.40	3.625	92.10	3.375	85.70	DT19RTB250100-##	
2 1/2 x 1 1/2	63.50 x 38.10	3.625	92.10	3.375	85.70	DT19RTB250150-##	
2 1/2 x 2	63.50 x 50.80	3.625	92.10	3.375	85.70	DT19RTB250200-##	
3 x 1/2	76.20 x 12.70	3.875	98.40	3.625	92.10	DT19RTB300050-##	
3 x 3/4	76.20 x 19.05	3.875	98.40	3.625	92.10	DT19RTB300075-##	
3 x 1	76.20 x 25.40	3.875	98.40	3.625	92.10	DT19RTB300100-##	
3 x 1 1/2	76.20 x 38.10	3.875	98.40	3.625	92.10	DT19RTB300150-##	
3 x 2	76.20 x 50.80	3.875	98.40	3.625	92.10	DT19RTB300200-##	
3 x 2 1/2	76.20 x 63.50	3.875	98.40	3.625	92.10	DT19RTB300250-##	
4 x 1/2	101.60 x 12.70	4.750	120.70	4.125	104.80	DT19RTB400050-##	
4 x 3/4	101.60 x 19.05	4.750	120.70	4.125	104.80	DT19RTB400075-##	
4 x 1	101.60 x 25.40	4.750	120.70	4.125	104.80	DT19RTB400100-##	
4 x 1 1/2	101.60 x 38.10	4.750	120.70	4.125	104.80	DT19RTB400150-##	
4 x 2	101.60 x 50.80	4.750	120.70	4.375	111.10	DT19RTB400200-##	
4 x 2 1/2	101.60 x 63.50	4.750	120.70	4.375	111.10	DT19RTB400250-##	
4 x 3	101.60 x 76.20	4.750	120.70	4.375	111.10	DT19RTB400300-##	
6 x 3	152.40 x 76.20	7.125	181.00	5.375	136.50	DT19RTB600300-##	
6 x 4	152.40 x 101.60	7.125	181.00	5.750	146.10	DT19RTB600400-##	



# DT-20

## DT-4.1.2-9

Short Outlet Reducing Tee CCC

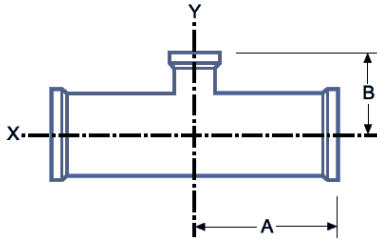

Nominal Size		A		B		SF1	SF4
Inch	mm	Inch	mm	Inch	mm	##=F1	##=F4
3/8 x 1/4	9.53 x 6.35	2.250	57.20	1.000	25.40	DT20RTB038025-##	
1/2 x 1/4	12.70 x 6.35	2.375	60.30	1.000	25.40	DT20RTB050025-##	
1/2 X 3/8	12.70 X 9.53	2.375	60.30	1.000	25.40	DT20RTB050038-##	
3/4 x 1/4	19.05 x 6.35	2.500	63.50	1.000	25.40	DT20RTB075025-##	
3/4 x 3/8	19.05 x 9.53	2.500	63.50	1.000	25.40	DT20RTB075038-##	
3/4 x 1/2	19.05 x 12.70	2.500	63.50	1.000	25.40	DT20RTB075050-##	
1 x 1/4	25.40 x 6.35	2.625	66.70	1.125	28.60	DT20RTB100025-##	
1 x 3/8	25.40 x 9.53	2.625	66.70	1.125	28.60	DT20RTB100038-##	
1 x 1/2	25.40 x 12.70	2.625	66.70	1.125	28.60	DT20RTB100050-##	
1 x 3/4	25.40 x 19.05	2.625	66.70	1.125	28.60	DT20RTB100075-##	
1 1/2 x 1/2	38.10 x 12.70	2.875	73.00	1.375	34.90	DT20RTB150050-##	
1 1/2 x 3/4	38.10 x 19.05	2.875	73.00	1.375	34.90	DT20RTB150075-##	
1 1/2 x 1	38.10 x 25.40	2.875	73.00	1.375	34.90	DT20RTB150100-##	
2 x 1/2	50.80 x 12.70	3.375	85.70	1.625	41.30	DT20RTB200050-##	
2 x 3/4	50.80 x 19.05	3.375	85.70	1.625	41.30	DT20RTB200075-##	
2 x 1	50.80 x 25.40	3.375	85.70	1.625	41.30	DT20RTB200100-##	
2 x 1 1/2	50.80 x 38.10	3.375	85.70	1.625	41.30	DT20RTB200150-##	
2 1/2 x 1/2	63.50 x 12.70	3.625	92.10	1.875	47.60	DT20RTB250050-##	
2 1/2 x 3/4	63.50 x 19.05	3.625	92.10	1.875	47.60	DT20RTB250075-##	
2 1/2 x 1	63.50 x 25.40	3.625	92.10	1.875	47.60	DT20RTB250100-##	
2 1/2 x 1 1/2	63.50 x 38.10	3.625	92.10	1.875	47.60	DT20RTB250150-##	
2 1/2 x 2	63.50 x 50.80	3.625	92.10	1.875	47.60	DT20RTB250200-##	
3 x 1/2	76.20 x 12.70	3.875	98.40	2.125	54.00	DT20RTB300050-##	
3 x 3/4	76.20 x 19.05	3.875	98.40	2.125	54.00	DT20RTB300075-##	
3 x 1	76.20 x 25.40	3.875	98.40	2.125	54.00	DT20RTB300100-##	
3 x 1 1/2	76.20 x 38.10	3.875	98.40	2.125	54.00	DT20RTB300250-##	
3 x 2	76.20 x 50.80	3.875	98.40	2.125	54.00	DT20RTB300200-##	
3 x 2 1/2	76.20 x 63.50	3.875	98.40	2.125	54.00	DT20RTB300250-##	
4 x 1/2	101.60 x 12.70	4.750	120.70	2.625	66.70	DT20RTB400050-##	
4 x 3/4	101.60 x 19.05	4.750	120.70	2.625	66.70	DT20RTB400075-##	
4 x 1	101.60 x 25.40	4.750	120.70	2.625	66.70	DT20RTB400100-##	
4 x 1 1/2	101.60 x 38.10	4.750	120.70	2.625	66.70	DT20RTB400150-##	
4 x 2	101.60 x 50.80	4.750	120.70	2.625	66.70	DT20RTB400200-##	
4 x 2 1/2	101.60 x 63.50	4.750	120.70	2.625	66.70	DT20RTB400250-##	
4 x 3	101.60 x 76.20	4.750	120.70	2.625	66.70	DT20RTB400300-##	
6 x 1/2	152.40 x 12.70	7.125	7.125	3.625	92.10	DT20RTB600050-##	
6 x 3/4	152.40 x 19.05	7.125	7.125	3.625	92.10	DT20RTB600075-##	
6 x 1	152.40 x 25.40	7.125	7.125	3.625	92.10	DT20RTB600100-##	
6 x 1 1/2	152.40 x 38.40	7.125	7.125	3.625	92.10	DT20RTB600150-##	
6 x 2	152.40 x 50.80	7.125	7.125	3.625	92.10	DT20RTB600200-##	
6 x 2 1/2	152.40 x 63.50	7.125	7.125	3.625	92.10	DT20RTB600250-##	
6 x 3	152.40 x 76.20	7.125	181.00	3.625	92.10	DT20RTB600300-##	
6 x 4	152.40 x 101.60	7.125	181.00	3.750	95.30	DT20RTB600400-##	

# DT-21C(a)

Concentric Reducer CC

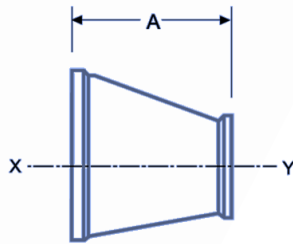

Nominal Size		A		SF1	SF4
Inch	mm	Inch	mm	##=F1	##=F4
3/4 x 1/2	19.05 x 12.70	2.000	50.80	DT21CB075050-##	
1 x 1/2	25.40 x 12.70	2.500	63.50	DT21CB100050-##	
1 x 3/4	25.40 x 19.05	2.000	50.80	DT21CB100075-##	
1 1/2 x 1/2	38.10 x 12.70	3.500	88.90	DT21CB150050-##	
1 1/2 x 3/4	38.10 x 19.05	3.000	76.20	DT21CB150075-##	
1 1/2 x 1	38.10 x 25.40	3.000	76.20	DT21CB150100-##	
2 x 1/2	50.80 x 12.70	5.500	139.70	DT21CB200050-##	
2 x 3/4	50.80 x 19.05	5.000	127.00	DT21CB200075-##	
2 x 1	50.80 x 25.40	5.000	127.00	DT21CB200100-##	
2 x 1 1/2	50.80 x 38.10	3.000	76.20	DT21CB200150-##	
2 1/2 x 1/2	63.50 x 12.70	7.500	190.50	DT21CB250050-##	
2 1/2 x 3/4	63.50 x 19.05	7.000	177.80	DT21CB250075-##	
2 1/2 x 1	63.50 x 25.40	7.000	177.80	DT21CB250100-##	
2 1/2 x 1 1/2	63.50 x 38.10	5.000	127.00	DT21CB250150-##	
2 1/2 x 2	63.50 x 50.80	3.000	76.20	DT21CB250200-##	
3 x 1	76.20 x 25.40	9.000	228.60	DT12CB300100-##	
3 x 1 1/2	76.20 x 38.10	7.000	177.80	DT21CB300150-##	
3 x 2	76.20 x 50.80	5.000	127.00	DT21CB300200-##	
3 x 2 1/2	76.20 x 63.50	3.000	76.20	DT21CB300250-##	
4 x 1	101.60 x 25.40	13.125	333.40	DT21CB400100-##	
4 x 1 1/2	101.60 x 38.10	11.125	282.60	DT21CB400150-##	
4 x 2	101.60 x 50.80	9.125	231.80	DT21CB400200-##	
4 x 2 1/2	101.60 x 63.50	7.125	181.00	DT21CB400250-##	
4 x 3	101.60 x 76.20	5.125	130.20	DT21CB400300-##	
6 x 3	152.40 x 76.20	7.500	190.50	DT21CB600300-##	
6 x 4	152.40 x 101.60	7.625	193.70	DT21CB600400-##	

# DT-21E(a)

Eccentric Reducer CC

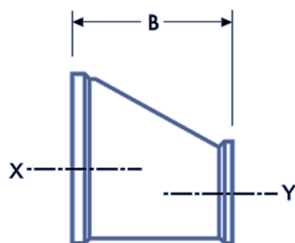

Nominal Size		A		SF1	SF4
Inch	mm	Inch	mm	##=F1	##=F4
3/4 x 1/2	19.05 x 12.70	2.000	50.80	DT21EB075050-##	
1 x 1/2	25.40 x 12.70	2.500	63.50	DT21EB100050-##	
1 x 3/4	25.40 x 19.05	2.000	50.80	DT21EB100075-##	
1 1/2 x 1/2	38.10 x 12.70	3.500	88.90	DT21EB150050-##	
1 1/2 x 3/4	38.10 x 19.05	3.000	76.20	DT21EB105075-##	
1 1/2 x 1	38.10 x 25.40	3.000	76.20	DT21EB150100-##	
2 x 1/2	50.80 x 12.70	5.500	139.70	DT21EB200050-##	
2 x 3/4	50.80 x 19.05	5.000	127.00	DT21EB200075-##	
2 x 1	50.80 x 25.40	5.000	127.00	DT21EB200100-##	
2 x 1 1/2	50.80 x 38.10	3.000	76.20	DT21EB200150-##	
2 1/2 x 1/2	63.50 x 12.70	7.500	190.50	DT21EB250050-##	
2 1/2 x 3/4	63.50 x 19.05	7.000	177.80	DT21EB250075-##	
2 1/2 x 1	63.50 x 25.40	7.000	177.80	DT21EB250100-##	
2 1/2 x 1 1/2	63.50 x 38.10	5.000	127.00	DT21EB250150-##	
2 1/2 x 2	63.50 x 50.80	3.000	76.20	DT21EB250200-##	
3 x 1	76.20 x 25.40	9.000	228.60	DT21EB300100-##	
3 x 1 1/2	76.20 x 38.10	7.000	177.80	DT21EB300150-##	
3 x 2	76.20 x 50.80	5.000	127.00	DT21EB300200-##	
3 x 2 1/2	76.20 x 63.50	3.000	76.20	DT21EB300250-##	
4 x 1	101.60 x 25.40	13.125	333.40	DT21EB400100-##	
4 x 1 1/2	101.60 x 38.10	11.125	282.60	DT21EB400150-##	
4 x 2	101.60 x 50.80	9.125	231.80	DT21EB400200-##	
4 x 2 1/2	101.60 x 63.50	7.125	181.00	DT21EB400250-##	
4 x 3	101.60 x 76.20	5.125	130.20	DT21EB400300-##	
6 x 3	152.40 x 76.20	7.625	193.70	DT21EB600300-##	
6 x 4	152.40 x 101.60	7.625	193.70	DT21EB600400-##	

# DT-21C(b)

DT-4.1.3-3

Concentric Reducer CC

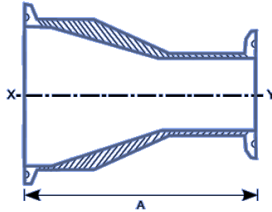

Nominal Size		A		SF1	SF4
Inch	mm	Inch	mm	##=F1	##=F4
3/8 x 1/4	9.53 x 6.35	2.625	66.70	DT21CBB038025-##	
1/2 x 1/4	12.70 x 6.35	2.875	73.00	DT21CBB050024-##	
1/2 x 3/8	12.70 x 9.53	2.875	73.00	DT21CBB050038-##	
3/4 x 3/8	19.05 x 9.53	3.000	76.20	DT21CBB075038-##	
3/4 x 1/2	19.05 x 12.70	3.125	79.40	DT21CBB075050-##	
1 x 1/2	25.40 x 12.70	3.500	88.90	DT21CBB100050-##	
1 x 3/4	25.40 x 19.05	3.125	79.40	DT21CBB100075-##	
1 1/2 x 3/4	38.10 x 19.05	4.000	101.60	DT21CBB150075-##	
1 1/2 x 1	38.10 x 25.40	3.500	88.90	DT21CBB150100-##	
2 x 1	50.80 x 25.40	4.375	111.10	DT21CBB200100-##	
2 x 1 1/2	50.80 x 38.10	3.500	88.90	DT21CBB200150-##	
2 1/2 x 1 1/2	63.50 x 38.10	4.375	111.10	DT21CBB250150-##	
2 1/2 x 2	63.50 x 50.80	3.500	88.90	DT21CBB250200-##	
3 x 1 1/2	76.20 x 38.10	5.250	133.40	DT21CBB300150-##	
3 x 2	76.20 x 50.80	4.375	111.10	DT21CBB300200-##	
3 x 2 1/2	76.20 x 63.50	3.625	92.10	DT21CBB300250-##	
4 x 2	101.60 x 50.80	6.250	158.80	DT21CBB400200-##	
4 x 2 1/2	101.60 x 63.50	5.375	136.50	DT21CBB400250-##	
4 x 3	101.60 x 76.20	5.000	127.00	DT21CBB400300-##	
6 x 3	152.40 x 76.20	8.500	215.90	DT21CBB600300-##	
6 x 4	152.40 x 101.60	7.000	177.80	DT21CBB600400-##	

# DT-21C(b)

DT-4.1.3-3

Concentric Reducer CC

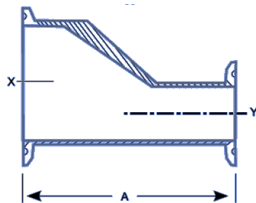

Nominal Size		A		SF1	SF4
Inch	mm	Inch	mm	##=F1	##=F4
3/8 x 1/4	9.53 x 6.35	2.625	66.70	DT21EBB038025-##	
1/2 x 1/4	12.70 x 6.35	2.875	73.00	DT21EBB050024-##	
1/2 x 3/8	12.70 x 9.53	2.875	73.00	DT21EBB050038-##	
3/4 x 3/8	19.05 x 9.53	3.000	76.20	DT21EBB075038-##	
3/4 x 1/2	19.05 x 12.70	3.125	79.40	DT21EBB075050-##	
1 x 1/2	25.40 x 12.70	3.500	88.90	DT21EBB100050-##	
1 x 3/4	25.40 x 19.05	3.125	79.40	DT21EBB100075-##	
1 1/2 x 3/4	38.10 x 19.05	4.000	101.60	DT21EBB150075-##	
1 1/2 x 1	38.10 x 25.40	3.500	88.90	DT21EBB150100-##	
2 x 1	50.80 x 25.40	4.375	111.10	DT21EBB200100-##	
2 x 1 1/2	50.80 x 38.10	3.500	88.90	DT21EBB200150-##	
2 1/2 x 1 1/2	63.50 x 38.10	4.375	111.10	DT21EBB250150-##	
2 1/2 x 2	63.50 x 50.80	3.500	88.90	DT21EBB250200-##	
3 x 1 1/2	76.20 x 38.10	5.250	133.40	DT21EBB300150-##	
3 x 2	76.20 x 50.80	4.375	111.10	DT21EBB300200-##	
3 x 2 1/2	76.20 x 63.50	3.625	92.10	DT21EBB300250-##	
4 x 2	101.60 x 50.80	6.250	158.80	DT21EBB400200-##	
4 x 2 1/2	101.60 x 63.50	5.375	136.50	DT21EBB400250-##	
4 x 3	101.60 x 76.20	5.000	127.00	DT21EBB400300-##	
6 x 3	152.40 x 76.20	8.500	215.90	DT21EBB600300-##	
6 x 4	152.40 x 101.60	7.000	177.80	DT21EBB600400-##	

# DT-22A

# DT-22B

# DT-22C

## DT-4.1.4-1

Ferrule

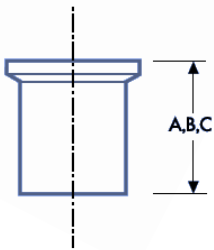

Nominal Size		A		DT-22A		B		DT-22B		C		DT-22C	
Inch	mm	Inch	mm	SF1 ##=F1	SF4 ##=F4	Inch	mm	SF1 ##=F1	SF4 ##=F4	Inch	mm	SF1 ##=F1	SF4 ##=F4
1/4	6.35	1.750	44.50	DT22AB025-##		1.130	28.70	DT22BB025-##		0.500	12.70	DT22CB025-##	
3/8	9.53	1.750	44.50	DT22AB038-##		1.130	28.70	DT22BB038-##		0.500	12.70	DT22CB038-##	
1/2	12.70	1.750	44.50	DT22AB050-##		1.130	28.70	DT22BB050-##		0.500	12.70	DT22CB050-##	
3/4	19.05	1.750	44.50	DT22AB075-##		1.130	28.70	DT22BB075-##		0.500	12.70	DT22CB075-##	
1	25.40	1.750	44.50	DT22AB100-##		1.130	28.70	DT22BB100-##		0.500	12.70	DT22CB100-##	
1 1/2	38.10	1.750	44.50	DT22AB150-##		1.130	28.70	DT22BB150-##		0.500	12.70	DT22CB150-##	
2	50.80	2.250	57.20	DT22AB200-##		1.130	28.70	DT22BB200-##		0.500	12.70	DT22CB200-##	
2 1/2	63.50	2.250	57.20	DT22AB250-##		1.130	28.70	DT22BB250-##		0.500	12.70	DT22CB250-##	
3	76.20	2.250	57.20	DT22AB300-##		1.130	28.70	DT22BB300-##		0.500	12.70	DT22CB300-##	
4	101.60	2.250	57.20	DT22AB400-##		1.130	28.70	DT22BB400-##		0.625	15.90	DT22CB400-##	
6	152.40	3.000	76.20	DT22AB600-##		1.500	38.10	DT22BB600-##		0.750	19.10	DT22CB600-##	

# DT-23

## DT-4.1.1-7

180° Return Bend WW

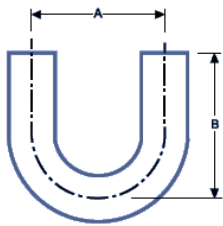

Nominal Size		A		B		SF1	SF4
Inch	mm	Inch	mm	Inch	mm	##=F1	##=F4
1/4	6.35	4.500	114.30	2.625	66.70	DT23B025-##	
3/8	9.53	4.500	114.30	2.625	66.70	DT23B038-##	
1/2	12.70	4.500	114.30	3.000	76.20	DT23B050-##	
3/4	19.05	4.500	114.30	3.000	76.20	DT23B075-##	
1	25.40	3.000	76.20	3.000	76.20	DT23B100-##	
1 1/2	38.10	4.500	114.30	4.500	114.30	DT23B150-##	
2	50.80	6.000	152.40	5.000	127.00	DT23B200-##	
2 1/2	63.50	7.500	190.50	5.750	146.10	DT23B250-##	
3	76.20	9.000	228.60	6.500	165.10	DT23B300-##	
4	101.60	12.000	304.80	8.500	215.90	DT23B400-##	
6	152.40	18.000	457.20	11.500	292.10	DT23B600-##	

# DT-23T

180° Tee Bottom  
Outlet WCW

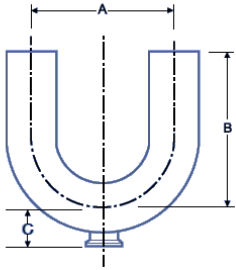

Nominal Size		A		B		C		SF1	SF4
Inch	mm	Inch	mm	Inch	mm	Inch	mm	##=F1	##=F4
1 x 1/2	25.40 x 12.70	3.000	76.20	3.000	76.20	1.125	28.58	DT23OB100050-##	
1 x 3/4	25.40 x 19.05	3.000	76.20	3.000	76.20	1.125	28.58	DT23OB100075-##	
1 x 1	25.40 x 25.40	3.000	76.20	3.000	76.20	1.125	28.58	DT23OB100100-##	
1 1/2 x 1/2	38.10 x 12.70	4.500	114.30	4.500	114.30	1.375	34.93	DT23OB150050-##	
1 1/2 x 3/4	38.10 x 19.05	4.500	114.30	4.500	114.30	1.375	34.93	DT23OB150075-##	
1 1/2 x 1	38.10 x 25.40	4.500	114.30	4.500	114.30	1.375	34.93	DT23OB150100-##	
1 1/2 x 1 1/2	38.10 x 38.10	4.500	114.30	4.500	114.30	1.375	34.93	DT23OB150150-##	
2 x 1/2	50.80 x 12.70	6.000	152.40	5.000	127.00	1.625	41.28	DT23OB200050-##	
2 x 3/4	50.80 x 19.05	6.000	152.40	5.000	127.00	1.625	41.28	DT23OB200075-##	
2 x 1	50.80 x 25.40	6.000	152.40	5.000	127.00	1.625	41.28	DT23OB200100-##	
2 x 1 1/2	50.80 x 38.10	6.000	152.40	5.000	127.00	1.625	41.28	DT23OB200150-##	
2 x 2	50.80 x 50.80	6.000	152.40	5.000	127.00	1.625	41.28	DT23OB200200-##	
2 1/2 x 1/2	63.50 x 12.70	7.500	190.50	5.750	146.05	1.875	47.63	DT23OB250050-##	
2 1/2 x 3/4	63.50 x 19.05	7.500	190.50	5.750	146.05	1.875	47.63	DT23OB250075-##	
2 1/2 x 1	63.50 x 25.40	7.500	190.50	5.750	146.05	1.875	47.63	DT23OB250100-##	
2 1/2 x 1 1/2	63.50 x 38.10	7.500	190.50	5.750	146.05	1.875	47.63	DT23OB250150-##	
2 1/2 x 2	63.50 x 50.80	7.500	190.50	5.750	146.05	1.875	47.63	DT23OB250200-##	
2 1/2 x 2 1/2	63.50 x 63.50	7.500	190.50	5.750	146.05	1.875	47.63	DT23OB250250-##	
3 x 1/2	76.20 x 12.70	9.000	228.60	6.500	165.10	2.125	53.98	DT23OB300050-##	
3 x 3/4	76.20 x 19.05	9.000	228.60	6.500	165.10	2.125	53.98	DT23OB300075-##	
3 x 1	76.20 x 25.40	9.000	228.60	6.500	165.10	2.125	53.98	DT23OB300100-##	
3 x 1 1/2	76.20 x 38.10	9.000	228.60	6.500	165.10	2.125	53.98	DT23OB300150-##	
3 x 2	76.20 x 50.80	9.000	228.60	6.500	165.10	2.125	53.98	DT23OB300200-##	
3 x 2 1/2	76.20 x 63.50	9.000	228.60	6.500	165.10	2.125	53.98	DT23OB300250-##	
3 x 3	76.20 x 76.20	9.000	228.60	6.500	165.10	2.125	53.98	DT23OB300300-##	
4 x 1/2	101.60 x 12.70	12.000	304.80	8.500	215.90	2.625	66.68	DT23OB400050-##	
4 x 3/4	101.60 x 19.05	12.000	304.80	8.500	215.90	2.625	66.68	DT23OB400075-##	
4 x 1	101.60 x 25.40	12.000	304.80	8.500	215.90	2.625	66.68	DT23OB400100-##	
4 x 1 1/2	101.60 x 38.10	12.000	304.80	8.500	215.90	2.625	66.68	DT23OB400150-##	
4 x 2	101.60 x 50.80	12.000	304.80	8.500	215.90	2.625	66.68	DT23OB400200-##	
4 x 2 1/2	101.60 x 63.50	12.000	304.80	8.500	215.90	2.625	66.68	DT23OB400250-##	
4 x 3	101.60 x 76.20	12.000	304.80	8.500	215.90	2.625	66.68	DT23OB400300-##	
4 x 4	101.60 x 101.60	12.000	304.80	8.500	215.90	2.625	66.68	DT23OB400400-##	

# DT-24

DT-4.1.1-8

180° Return Bend CC

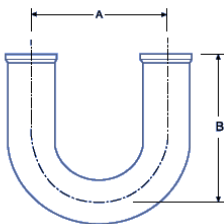

Nominal Size		A		B		SF1	SF4
Inch	mm	Inch	mm	Inch	mm	##=F1	##=F4
1/4	6.35	4.500	114.30	3.125	79.40	DT24OB025-##	
3/8	9.53	4.500	114.30	3.125	79.40	DT24OB038-##	
1/2	12.70	4.500	114.30	3.500	88.90	DT24OB050-##	
3/4	19.05	4.500	114.30	3.500	88.90	DT24OB075-##	
1	25.40	3.000	76.20	3.500	88.90	DT24OB100-##	
1 1/2	38.10	4.500	114.30	5.000	127.00	DT24OB150-##	
2	50.80	6.000	152.40	5.500	139.70	DT24OB200-##	
2 1/2	63.50	7.500	190.50	6.250	158.80	DT24OB250-##	
3	76.20	9.000	228.60	7.000	177.80	DT24OB300-##	
4	101.60	12.000	304.80	9.125	231.80	DT24OB400-##	
6	152.40	18.000	457.20	13.000	330.20	DT24OB600-##	

# DT-25

## DT-4.1.2-3

Short Outlet Run Tee WWC

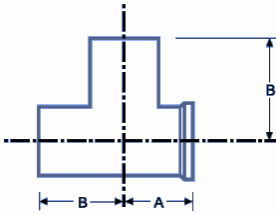

Nominal Size		A		B		SF1	SF4
Inch	mm	Inch	mm	Inch	mm	##=F1	##=F4
1/4	6.35	0.875	22.20	1.750	44.50	DT25RTB025-##	
3/8	9.53	0.875	22.20	1.750	44.50	DT25RTB038-##	
1/2	12.70	0.875	22.20	1.875	47.60	DT25RTB050-##	
3/4	19.05	1.000	25.40	2.000	50.80	DT25RTB075-##	
1	25.40	1.125	28.60	2.125	54.00	DT25RTB100-##	
1 1/2	38.10	1.375	34.90	2.375	60.30	DT25RTB150-##	
2	50.80	1.625	41.30	2.875	73.00	DT25RTB200-##	
2 1/2	63.50	1.875	47.60	3.125	79.40	DT25RTB250-##	
3	76.20	2.125	54.00	3.375	85.70	DT25RTB300-##	
4	101.60	2.750	69.90	4.125	104.80	DT25RTB400-##	
6	152.40	4.625	117.50	5.625	142.90	DT25RTB600-##	

# DT-26C(a)

Concentric Reducer CW

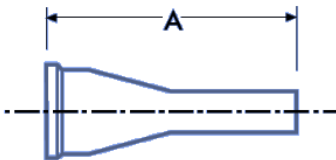

Nominal Size		A		SF1	SF4
Inch	mm	Inch	mm	##=F1	##=F4
3/4 x 1/2	19.05 x 12.70	3.000	76.20	DT26CB075050-##	
1 x 1/2	25.40 x 12.70	3.500	88.90	DT26CB100050-##	
1 x 3/4	25.40 x 19.05	3.000	76.20	DT26CB100075-##	
1 1/2 x 1/2	38.10 x 12.70	4.500	114.30	DT26CB150050-##	
1 1/2 x 3/4	38.10 x 19.05	4.000	101.60	DT26CB150075-##	
1 1/2 x 1	38.10 x 25.40	4.000	101.60	DT26CB150100-##	
2 x 1/2	50.80 x 12.70	6.500	165.10	DT26CB200050-##	
2 x 3/4	50.80 x 19.05	6.000	152.40	DT26CB200075-##	
2 x 1	50.80 x 25.40	6.000	152.40	DT26CB200100-##	
2 x 1 1/2	50.80 x 38.10	4.000	101.60	DT26CB200150-##	
2 1/2 x 1/2	63.50 x 12.70	8.500	215.90	DT26CB250050-##	
2 1/2 x 3/4	63.50 x 19.05	8.000	203.20	DT26CB250075-##	
2 1/2 x 1	63.50 x 25.40	8.000	203.20	DT26CB250100-##	
2 1/2 x 1 1/2	63.50 x 38.10	6.000	152.40	DT26CB250150-##	
2 1/2 x 2	63.50 x 50.80	4.250	108.00	DT26CB250200-##	
3 x 1	76.20 x 25.40	10.000	254.00	DT26CB300100-##	
3 x 1 1/2	76.20 x 38.10	8.000	203.20	DT26CB300150-##	
3 x 2	76.20 x 50.80	6.250	158.80	DT26CB300200-##	
3 x 2 1/2	76.20 x 63.50	4.250	108.00	DT26CB300250-##	
4 x 1	101.60 x 25.40	14.125	358.80	DT26CB400100-##	
4 x 1 1/2	101.60 x 38.10	12.125	308.00	DT26CB400150-##	
4 x 2	101.60 x 50.80	10.375	263.50	DT26CB400200-##	
4 x 2 1/2	101.60 x 63.50	8.375	212.70	DT26CB400250-##	
4 x 3	101.60 x 76.20	6.375	161.90	DT26CB400300-##	
6 x 3	152.40 x 76.20	9.000	228.60	DT26CB600300-##	
6 x 4	152.40 x 101.60	9.000	228.60	DT26CB600400-##	

# DT-26E(a)

Eccentric Reducer CW

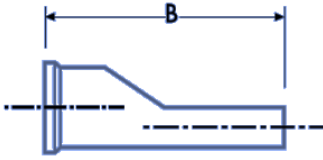

Nominal Size		A		SF1	SF4
Inch	mm	Inch	mm	##=F1	##=F4
3/4 x 1/2	19.05 x 12.70	3.000	76.20	DT26EB075050-##	
1 x 1/2	25.40 x 12.70	3.500	88.90	DT26EB100050-##	
1 x 3/4	25.40 x 19.05	3.000	76.20	DT26EB100075-##	
1 1/2 x 1/2	38.10 x 12.70	4.500	114.30	DT26EB150050-##	
1 1/2 x 3/4	38.10 x 19.05	4.000	101.60	DT26EB150075-##	
1 1/2 x 1	38.10 x 25.40	4.000	101.60	DT26EB150100-##	
2 x 1/2	50.80 x 12.70	6.500	165.10	DT26EB200050-##	
2 x 3/4	50.80 x 19.05	6.000	152.40	DT26EB200075-##	
2 x 1	50.80 x 25.40	6.000	152.40	DT26EB200100-##	
2 x 1 1/2	50.80 x 38.10	4.000	101.60	DT26EB200150-##	
2 1/2 x 1/2	63.50 x 12.70	8.500	215.90	DT26EB250050-##	
2 1/2 x 3/4	63.50 x 19.05	8.000	203.20	DT26EB250075-##	
2 1/2 x 1	63.50 x 25.40	8.000	203.20	DT26EB250100-##	
2 1/2 x 1 1/2	63.50 x 38.10	6.000	152.40	DT26EB250150-##	
2 1/2 x 2	63.50 x 50.80	4.250	108.00	DT26EB250200-##	
3 x 1	76.20 x 25.40	10.000	254.00	DT26EB300100-##	
3 x 1 1/2	76.20 x 38.10	8.000	203.20	DT26EB300150-##	
3 x 2	76.20 x 50.80	6.250	158.80	DT26EB300200-##	
3 x 2 1/2	76.20 x 63.50	4.250	108.00	DT26EB300250-##	
4 x 1	101.60 x 25.40	14.125	358.80	DT26EB400100-##	
4 x 1 1/2	101.60 x 38.10	12.125	308.00	DT26EB400150-##	
4 x 2	101.60 x 50.80	10.375	263.50	DT26EB400200-##	
4 x 2 1/2	101.60 x 63.50	8.375	212.70	DT26EB400250-##	
4 x 3	101.60 x 76.20	6.375	161.90	DT26EB400300-##	
6 x 3	152.40 x 76.20	8.750	222.30	DT26EB600300-##	
6 x 4	152.40 x 101.60	9.000	228.60	DT26EB600400-##	

# DT-26C(b)

DT-4.1.3-2

Concentric Reducer CW

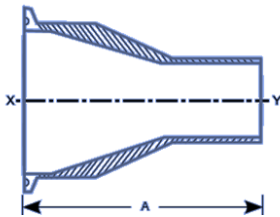

Nominal Size		A		SF1	SF4
Inch	mm	Inch	mm	##=F1	##=F4
3/8 x 1/4	9.53 x 6.35	2.125	54.00	DT26CBB038025-##	
1/2 x 1/4	12.70 x 6.35	2.375	60.30	DT26CBB050024-##	
1/2 x 3/8	12.70 x 9.53	2.375	60.30	DT26CBB050038-##	
3/4 x 3/8	19.05 x 9.53	2.500	63.50	DT26CBB075038-##	
3/4 x 1/2	19.05 x 12.70	2.625	66.70	DT26CBB075050-##	
1 x 1/2	25.40 x 12.70	3.000	76.20	DT26CBB100050-##	
1 x 3/4	25.40 x 19.05	2.625	66.70	DT26CBB100075-##	
1 1/2 x 3/4	38.10 x 19.05	3.500	88.90	DT26CBB150075-##	
1 1/2 x 1	38.10 x 25.40	3.000	76.20	DT26CBB150100-##	
2 x 1	50.80 x 25.40	3.875	98.40	DT26CBB200100-##	
2 x 1 1/2	50.80 x 38.10	3.000	76.20	DT26CBB200150-##	
2 1/2 x 1 1/2	63.50 x 38.10	3.875	98.40	DT26CBB250150-##	
2 1/2 x 2	63.50 x 50.80	3.000	76.20	DT26CBB250200-##	
3 x 1 1/2	76.20 x 38.10	4.750	120.70	DT26CBB300150-##	
3 x 2	76.20 x 50.80	3.875	98.40	DT26CBB300200-##	
3 x 2 1/2	76.20 x 63.50	3.125	79.40	DT26CBB300250-##	
4 x 2	101.60 x 50.80	5.750	146.10	DT26CBB400200-##	
4 x 2 1/2	101.60 x 63.50	4.875	123.80	DT26CBB400250-##	
4 x 3	101.60 x 76.20	4.500	114.30	DT26CBB400300-##	
6 x 3	152.40 x 76.20	8.000	203.20	DT26CBB600300-##	
6 x 4	152.40 x 101.60	6.375	161.90	DT26CBB600400-##	

# DT-26C(b)

## DT-4.1.3-2

Concentric Reducer CW

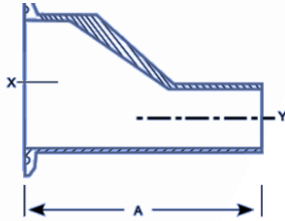

Nominal Size		A		SF1	SF4
Inch	mm	Inch	mm	##=F1	##=F4
3/8 x 1/4	9.53 x 6.35	2.125	54.00	DT26EBB038025-##	
1/2 x 1/4	12.70 x 6.35	2.375	60.30	DT26EBB050024-##	
1/2 x 3/8	12.70 x 9.53	2.375	60.30	DT26EBB050038-##	
3/4 x 3/8	19.05 x 9.53	2.500	63.50	DT26EBB075038-##	
3/4 x 1/2	19.05 x 12.70	2.625	66.70	DT26EBB075050-##	
1 x 1/2	25.40 x 12.70	3.000	76.20	DT26EBB100050-##	
1 x 3/4	25.40 x 19.05	2.625	66.70	DT26EBB100075-##	
1 1/2 x 3/4	38.10 x 19.05	3.500	88.90	DT26EBB150075-##	
1 1/2 x 1	38.10 x 25.40	3.000	76.20	DT26EBB150100-##	
2 x 1	50.80 x 25.40	3.875	98.40	DT26EBB200100-##	
2 x 1 1/2	50.80 x 38.10	3.000	76.20	DT26EBB200150-##	
2 1/2 x 1 1/2	63.50 x 38.10	3.875	98.40	DT26EBB250150-##	
2 1/2 x 2	63.50 x 50.80	3.000	76.20	DT26EBB250200-##	
3 x 1 1/2	76.20 x 38.10	4.750	120.70	DT26EBB300150-##	
3 x 2	76.20 x 50.80	3.875	98.40	DT26EBB300200-##	
3 x 2 1/2	76.20 x 63.50	3.125	79.40	DT26EBB300250-##	
4 x 2	101.60 x 50.80	5.750	146.10	DT26EBB400200-##	
4 x 2 1/2	101.60 x 63.50	4.875	123.80	DT26EBB400250-##	
4 x 3	101.60 x 76.20	4.500	114.30	DT26EBB400300-##	
6 x 3	152.40 x 76.20	8.000	203.20	DT26EBB600300-##	
6 x 4	152.40 x 101.60	6.375	161.90	DT26EBB600400-##	

# DT-27

## DT-4.1.2-5

Short Outlet Tee CCC

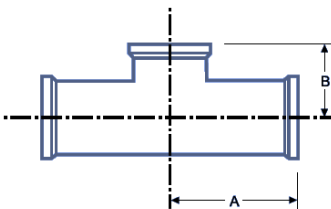

Nominal Size		A		B		SF1	SF4
Inch	mm	Inch	mm	Inch	mm	##=F1	##=F4
1/2	12.70	2.250	57.20	1.000	25.40	DT27STB050-##	
3/4	19.05	2.350	60.70	1.125	28.60	DT27STB075-##	
1	25.40	2.625	66.70	1.125	28.60	DT27STB100-##	
1 1/2	38.10	2.875	73.00	1.375	34.90	DT27STB150-##	
2	50.80	3.375	85.70	1.625	41.30	DT27STB200-##	
2 1/2	63.50	3.625	92.10	1.875	47.60	DT27STB250-##	
3	76.20	3.875	98.40	2.125	54.00	DT27STB300-##	
4	101.60	4.750	120.70	2.750	69.90	DT27STB400-##	
6	152.40	7.125	181.00	4.625	117.50	DT27STB600-##	



# DT-28

DT-4.1.2-10

Instrument Tee WCW

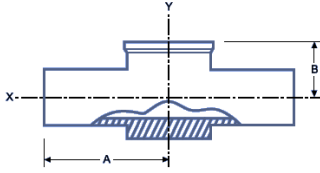

Nominal Size		A		B		SF1	SF4
Inch	mm	Inch	mm	Inch	mm	##=F1	##=F4
1/2 x 1 1/2	12.70 x 38.10	2.500	63.50	0.875	22.20	DT28ITB050150-##	
3/4 x 1 1/2	19.05 x 38.10	2.500	63.50	1.000	25.40	DT28ITB075150-##	
1 x 1 1/2	25.40 x 38.10	2.500	63.50	1.125	28.60	DT28ITB100150-##	
1/2 x 2	12.70 x 50.80	2.750	69.90	1.000	25.40	DT28ITB050200-##	
3/4 x 2	19.05 x 50.80	2.750	69.90	1.125	28.60	DT28ITB075200-##	
1 x 2	25.40 x 50.80	2.750	69.90	1.250	31.80	DT28ITB100200-##	
1 1/2 x 2	38.10 x 50.80	2.750	69.90	1.500	38.10	DT28ITB150200-##	

# DT-29

DT-4.1.2-11

Instrument Tee CCC

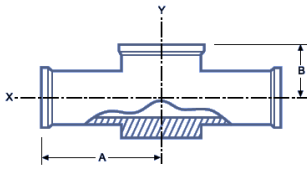

Nominal Size		A		B		SF1	SF4
Inch	mm	Inch	mm	Inch	mm	##=F1	##=F4
1/2 x 1 1/2	12.70 x 38.10	3.000	76.20	0.875	22.20	DT29ITB050150-##	
3/4 x 1 1/2	19.05 x 38.10	3.000	76.20	1.000	25.40	DT29ITB075150-##	
1 x 1 1/2	25.40 x 38.10	3.000	76.20	1.125	28.60	DT29ITB100150-##	
1/2 x 2	12.70 x 50.80	3.520	82.60	1.000	25.40	DT29ITB050200-##	
3/4 x 2	19.05 x 50.80	3.250	82.60	1.125	28.60	DT29ITB075200-##	
1 x 2	25.40 x 50.80	3.250	82.60	1.250	31.80	DT29ITB100200-##	
1 1/2 x 2	38.10 x 50.80	3.250	82.60	1.500	38.10	DT29ITB150200-##	

# DT-30

DT-4.1.5-1

Tube Weld End Cap

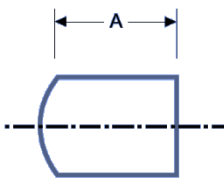

Nominal Size		A		SF1	SF4
Inch	mm	Inch	mm	##=F1	##=F4
1/2	12.70	1.500	38.10	DT30CB050-##	
3/4	19.05	1.500	38.10	DT30CB075-##	
1	25.40	1.500	38.10	DT30CB100-##	
1 1/2	38.10	1.500	38.10	DT30CB150-##	
2	50.80	1.500	38.10	DT30CB200-##	
2 1/2	63.50	1.500	38.10	DT30CB250-##	
3	76.20	1.750	44.50	DT30CB300-##	
4	101.60	2.000	50.80	DT30CB400-##	
6	152.40	2.500	63.50	DT30CB600-##	

# DT-31

DT-4.1.5-2

Solid End Cap

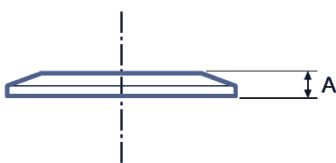

SECTION A-A

Nominal Size		A		SF1	SF4
Inch	mm	Inch	mm	##=F1	##=F4
1/4	6.35	0.187	4.70	DT31CB025-##	
3/8	9.53	0.187	4.70	DT31CB038-##	
1/2 & 3/4	12.70, 19.05	0.187	4.70	DT31CB050075-##	
1 & 1 1/2	25.40, 38.10	0.250	6.40	DT31CB100150-##	
2	50.80	0.250	6.40	DT31CB200-##	
2 1/2	63.50	0.250	6.40	DT31CB250-##	
3	76.20	0.250	6.40	DT31CB300-##	
4	101.60	0.312	7.90	DT31CB400-##	
6	152.40	0.437	11.10	DT31CB600-##	

# BSP ADAPTOR MALE IMPERIAL

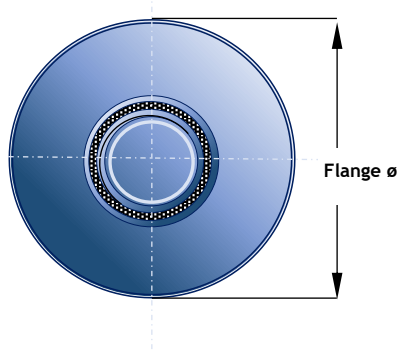
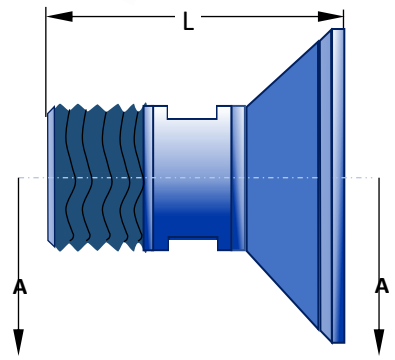
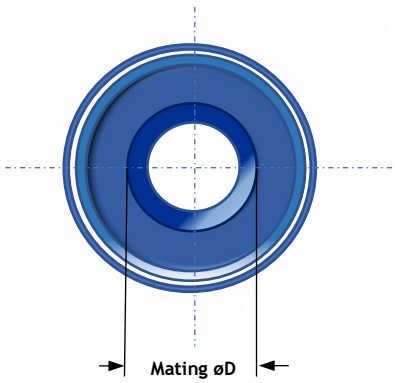

Ferrule size	Thread	Flange ø	Mating øD	Length L	Product code
Inch	Inch	mm	mm	mm	SF1
1/2	1/8	25.0	10.0	30	R11K204BSP0500125
1/2	1/4	25.0	10.0	30	R11K204BSP050025
1/2	3/8	25.0	10.0	30	R11K204BSP075038
1/2	1/2	25.0	10.0	32	R11K204BSP050050
1/2	3/4	25.0	10.0	35	R11K204BSP150075
3/4	1/8	25.0	16.0	30	R11K204BSP0750125
3/4	1/4	25.0	16.0	30	R11K204BSP075025
3/4	3/8	25.0	16.0	30	R11K204BSP075038
3/4	1/2	25.0	16.0	32	R11K204BSP075050
3/4	3/4	25.0	16.0	35	R11K204BSP075075
1	1/8	50.5	22.0	30	R11K204BSP1000125
1	1/4	50.5	22.0	30	R11K204BSP100025
1	3/8	50.5	22.0	30	R11K204BSP100038
1	1/2	50.5	22.0	35	R11K204BSP100050
1	3/4	50.5	22.0	35	R11K204BSP100075
1	1	50.5	22.0	35	R11K204BSP100100
1 1/2	1/8	50.5	35.0	35	R11K204BSP1500125
1 1/2	1/4	50.5	35.0	35	R11K204BSP150025
1 1/2	3/8	50.5	35.0	35	R11K204BSP150038
1 1/2	1/2	50.5	35.0	35	R11K204BSP150050
1 1/2	3/4	50.5	35.0	35	R11K204BSP150075
1 1/2	1	50.5	35.0	35	R11K204BSP150100
2	1/2	64.0	47.6	35	R11K204BSP200050
2	3/4	64.0	47.6	40	R11K204BSP200075
2	1	64.0	47.6	40	R11K204BSP200100
2	1 1/2	64.0	47.6	40	R11K204BSP200150
2	2	64.0	47.6	40	R11K204BSP200200

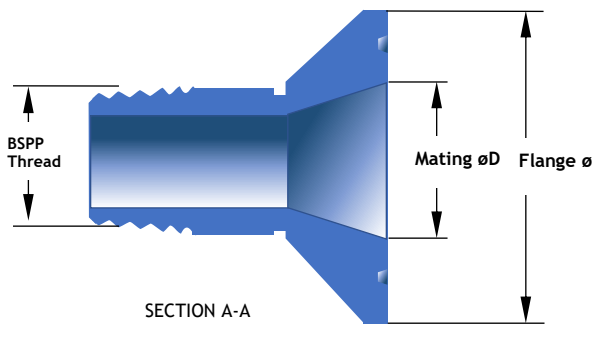

# BSP ADAPTOR FEMALE IMPERIAL

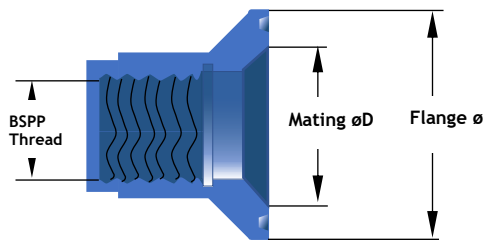
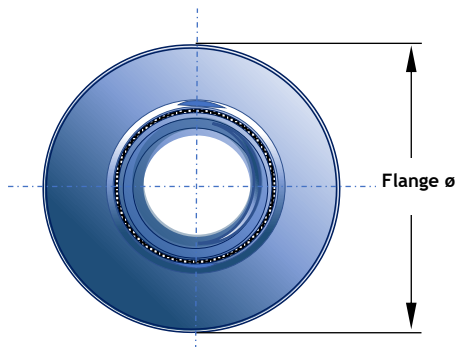
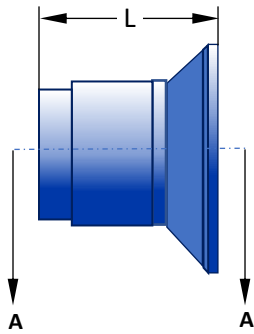
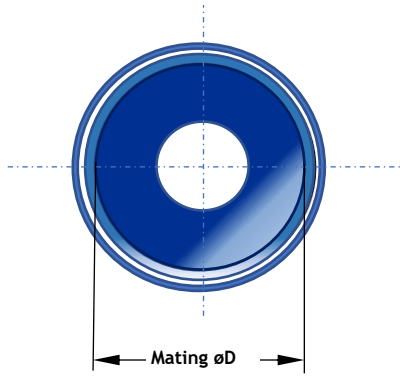

Ferrule size	Thread	Flange ø	Mating øD	Length L	Product code
Inch	Inch	mm	mm	mm	SFI
1/2	1/8	25.0	10.0	25	R11K205BSP0500125
1/2	1/4	25.0	10.0	25	R11K205BSP075025
1/2	3/8	25.0	10.0	25	R11K205BSP075038
1/2	1/2	25.0	10.0	30	R11K205BSP050050
1/2	3/4	25.0	10.0	30	R11K205BSP150075
3/4	1/8	25.0	16.0	25	R11K205BSP0750125
3/4	1/4	25.0	16.0	25	R11K205BSP075025
3/4	3/8	25.0	16.0	25	R11K205BSP075038
3/4	1/2	25.0	16.0	30	R11K205BSP075050
3/4	3/4	25.0	16.0	30	R11K205BSP075075
1	1/8	50.5	22.0	25	R11K205BSP1000125
1	1/4	50.5	22.0	25	R11K205BSP100025
1	3/8	50.5	22.0	25	R11K205BSP100038
1	1/2	50.5	22.0	25	R11K205BSP100050
1	3/4	50.5	22.0	25	R11K205BSP100075
1	1	50.5	47.6	25	R11K205BSP100100
1 1/2	1/8	50.5	35.0	25	R11K205BSP1500125
1 1/2	1/4	50.5	35.0	25	R11K205BSP150025
1 1/2	3/8	50.5	35.0	25	R11K205BSP150038
1 1/2	1/2	50.5	35.0	25	R11K205BSP150050
1 1/2	3/4	50.5	35.0	25	R11K205BSP150075
1 1/2	1	50.5	35.0	35	R11K205BSP150100
2	1/2	64.0	47.6	25	R11K205BSP200050
2	3/4	64.0	47.6	25	R11K205BSP200075
2	1	64.0	47.6	25	R11K205BSP200100
2	1 1/2	64.0	47.6	25	R11K205BSP200150
2	2	64.0	22.0	25	R11K205BSP200200

# ADAPTOR PIPE TO TUBE-PLAIN ENDED-SCH10

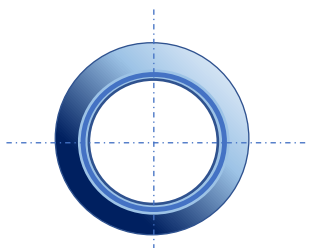
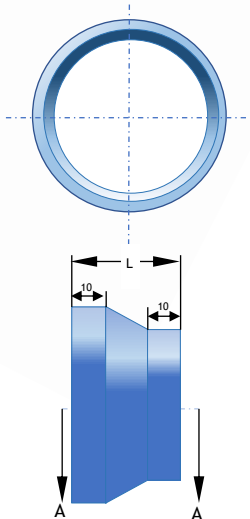

Pipe to Tube size	SCH10 øA	SCH10 øB	OD Tube øC	OD Tube øD	Length	Product code
Inch	mm	mm	mm	mm	mm	SF1
SCH10 1/2" to OD 1/2"	21.34	17.12	9.52	12.70	30	R1100420
SCH10 3/4" to OD 3/4"	26.67	22.45	15.78	19.05	30	R1100421
SCH10 1" to OD 1"	33.40	27.86	22.20	25.65	30	R1100422
SCH10 1 1/2" to OD 1 1/2"	48.26	42.72	34.90	38.35	30	R1100423
SCH10 2" to OD 2"	60.33	54.79	47.60	51.05	30	R1100424
SCH10 2 1/2" to OD 2 1/2"	73.03	66.93	60.30	63.75	30	R1100425
SCH10 3" to OD 3"	88.90	82.80	73.00	76.45	30	R1100426
SCH10 4" to OD 4"	114.30	108.20	97.60	101.85	30	R1100427
SCH10 6" to OD 6"	168.28	161.48	150.00	154.00	30	R1100428

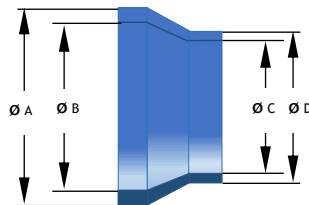

SECTION A-A

# STUB END

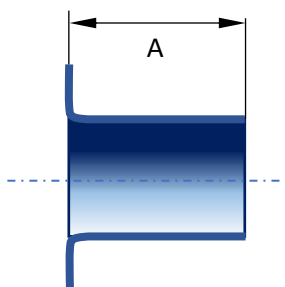

Nominal Size	A	Product Code
Inch	mm	SF1
0.5	50.8	R1100680
0.75	50.8	R1100681
1.0	69.8	R1100682
1.5	69.8	R1100683
2.0	69.8	R1100684
2.5	69.8	R1100685
3.0	69.8	R1100686
4.0	69.8	R1100687

# Quality

At Petrochem we are committed to providing customers with service of the highest possible level of quality. In order to achieve this, we are continually striving to improve our processes, products and services.

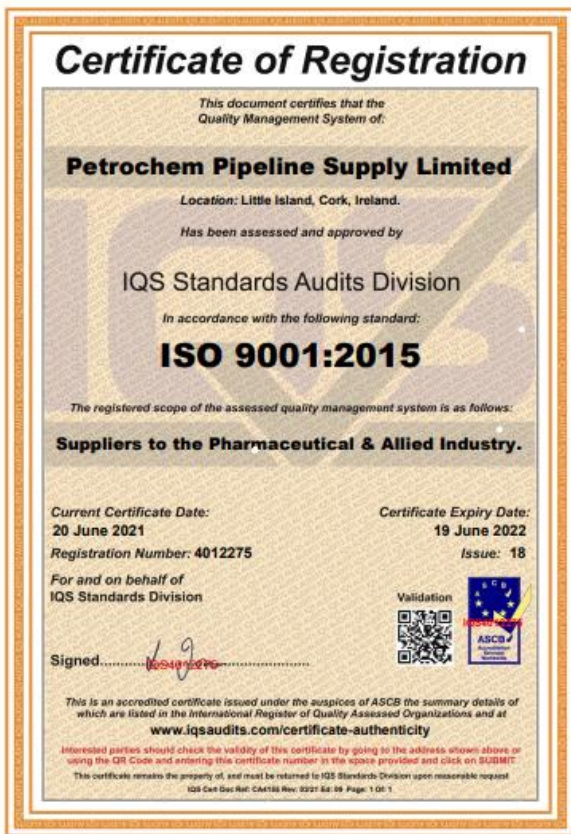

The implementation of the quality policy is the responsibility of all Petrochem staff members and all staff recognise and accept the philosophy, accepting accountability for their own output to allow the company to meet and exceed customer satisfaction at all times.



**PETROCHEM**  
BIOFLO SOLUTIONS



**PETROCHEM**  
GROUP



### **Petrochem Cork**

Unit 31,

Euro Business Park

Little Island,

Co. Cork

**Tel: +353 21 4351300**

**Email: [sales@petrochem.ie](mailto:sales@petrochem.ie)**

### **Petrochem Dunboyne**

Europa House,

Dunboyne Business Park

Dunboyne,

Co. Meath

**Tel: +353 1 8026020**

**Email: [dunboyne@petrochem.ie](mailto:dunboyne@petrochem.ie)**